

Pentura Mini LED

BNI30C

Mounting Instruction

IEC
60598

GB
7000

CE



t_a25°C

IP20

Product type	Voltage	Frequency	Power	CCT	Dimension (L×W×H. mm)	Weight (Kg)
BNI30C LED11S/840 PSU LI185	220-240~	50/60Hz	14W	4000K	1185×22×36	0.381
BNI30C LED10S/830 PSU LI185	220-240~	50/60Hz	14W	3000K	1185×22×36	0.381
BNI30C LED8S/840 PSU L885	220-240~	50/60Hz	10.8W	4000K	885×22×36	0.304
BNI30C LED8S/830 PSU L885	220-240~	50/60Hz	10.8W	3000K	885×22×36	0.304
BNI30C LED6S/840 PSU L585	220-240~	50/60Hz	7W	4000K	585×22×36	0.228
BNI30C LED5S/830 PSU L585	220-240~	50/60Hz	7W	3000K	585×22×36	0.228
BNI30C LED3S/840 PSU L325	220-240~	50/60Hz	4W	4000K	325×22×36	0.163
BNI30C LED3S/830 PSU L325	220-240~	50/60Hz	4W	3000K	325×22×36	0.163
Power Cable	220-240~	50/60Hz			165×20×11	0.016
L-Linable cord 265	220-240~	50/60Hz			265×20×11	0.022
L-Linable cord 600	220-240~	50/60Hz			600×20×11	0.027
Plug					19×10×13.5	0.002

Batten mounting

Installation on ceiling or wall through mounting clips.

Mounting distance(D)
Units (mm)

Type	L325	L585	L885/LI185
D	200-260	300-500	600-800

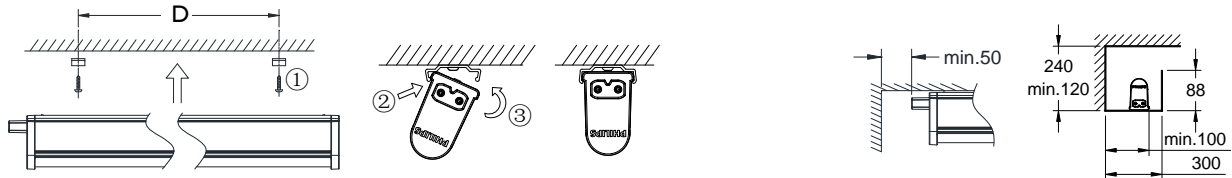

The recommended maximum number of battens linked together is eight.
Please switch off the power supply before changing the product or connection!
Max current of power cable: 1A.
Do not use the product in outdoor environments.

Luminaire installing and uninstalling

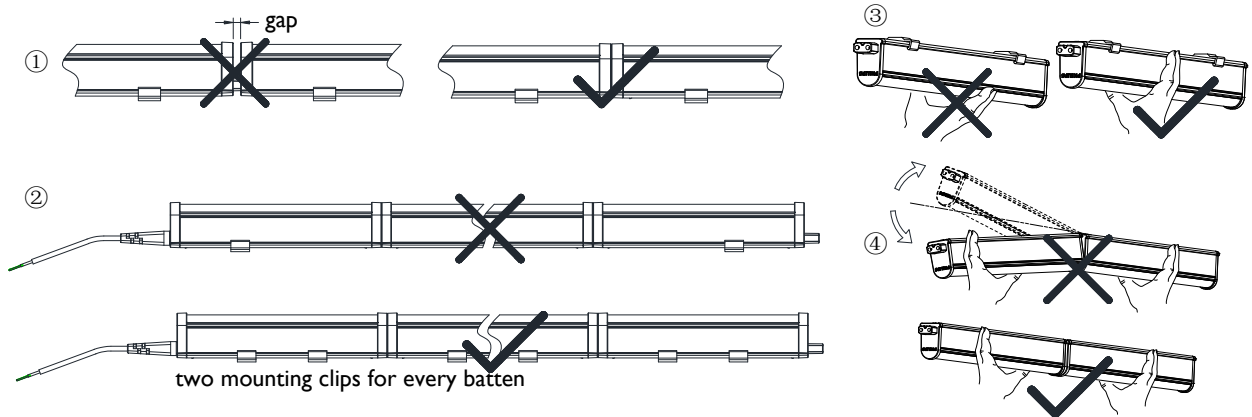

Do not move every one after luminaires are linked and installed.

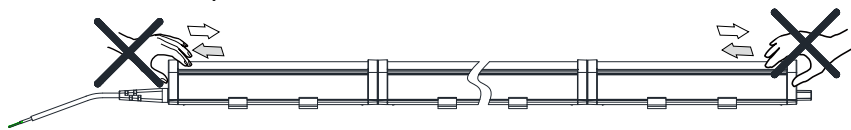

1 Wire connection I

Use 2-pin plug* for power connection.

*2-pin plug is not provided.

Wire spec: 0.75~1.5mm².

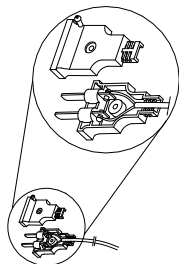

2 Wire connection II

Using wire connection box* for power connection.

*Wire connection box and Connector is not provided.

Connector dimensions:
10mm×20mm×25mm.

Connector should meet with wire spec
0.75~1.5mm².

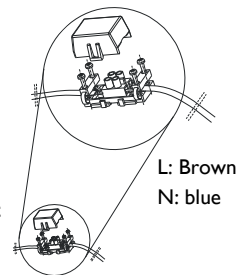

3 Trunking method I

Click fit male plug part into female socket. Affix next system, only after linking.

Maximum amount of linking: 8pcs

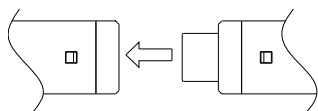

4 Trunking method II

Use connector jack cable(Not provided for L-Linable cord 600 in this pack) for linking, as required.

Maximum amount
of linking: 8pcs

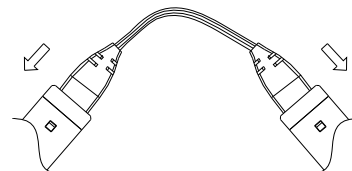

5 Plug installation

Insert to the plug for the last Batten

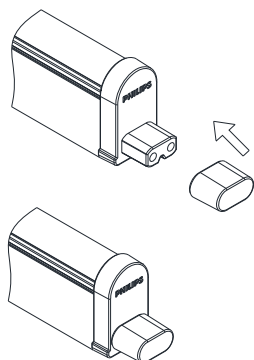

Inrush current

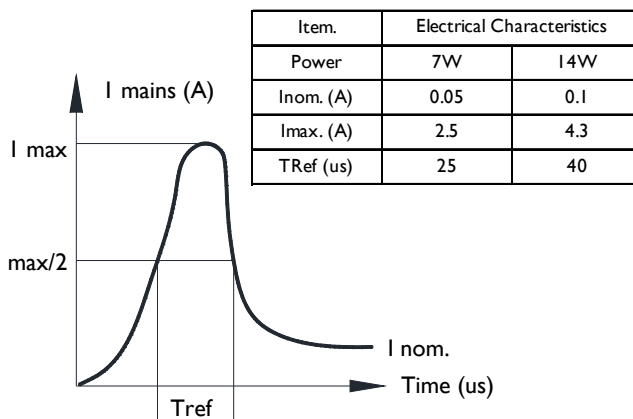

Matters Need Attention



1. The luminaire shall be installed by a qualified electrician and wired in accordance with the latest IEE electrical regulations or the national requirements.
2. The luminaire is complied to IEC 60598-1, CISPR 15 ed. 6 or GB 7000.1-2007, GB17743, GB17625.1.
3. Do not remove parts and the luminaire shall only be used completely with its glass shield.
If the glass shield, housing or power cables are damaged, the luminaire shall be destroyed.
4. The product is suitable for ceiling, surface & cove mounting.
5. Do not use in supply voltage exceeding 220-240V±10%(198~264V) for extended periods.
6. Do not place readily flammable material near the lamp.
7. In case of operation failure, please switch off the power and contact your nearest Philips dealer.
8. The manufacture will not be held responsible for improper usage or modification of the product.